

Zoning:
Olde Cypress DRI
Land Use:
Golf Course

Zoning:
HD - RPUD
Land Use:
Single Family Residential

Immokalee Road

Zoning:
Estates
Land Use:
Misc. Agriculture

Zoning:
Agriculture
Land Use:
Misc. Agriculture

Zoning:
Estates
Land Use:
Vacant
Residential

Zoning:
Agriculture
Land Use:
Misc. Agriculture

Zoning:
Agriculture
Land Use:
Misc. Agriculture

Zoning:
Agriculture
Land Use:
Misc. Agriculture

Zoning:
Agriculture
Land Use:
Misc. Agriculture

Saturnia
Lakes

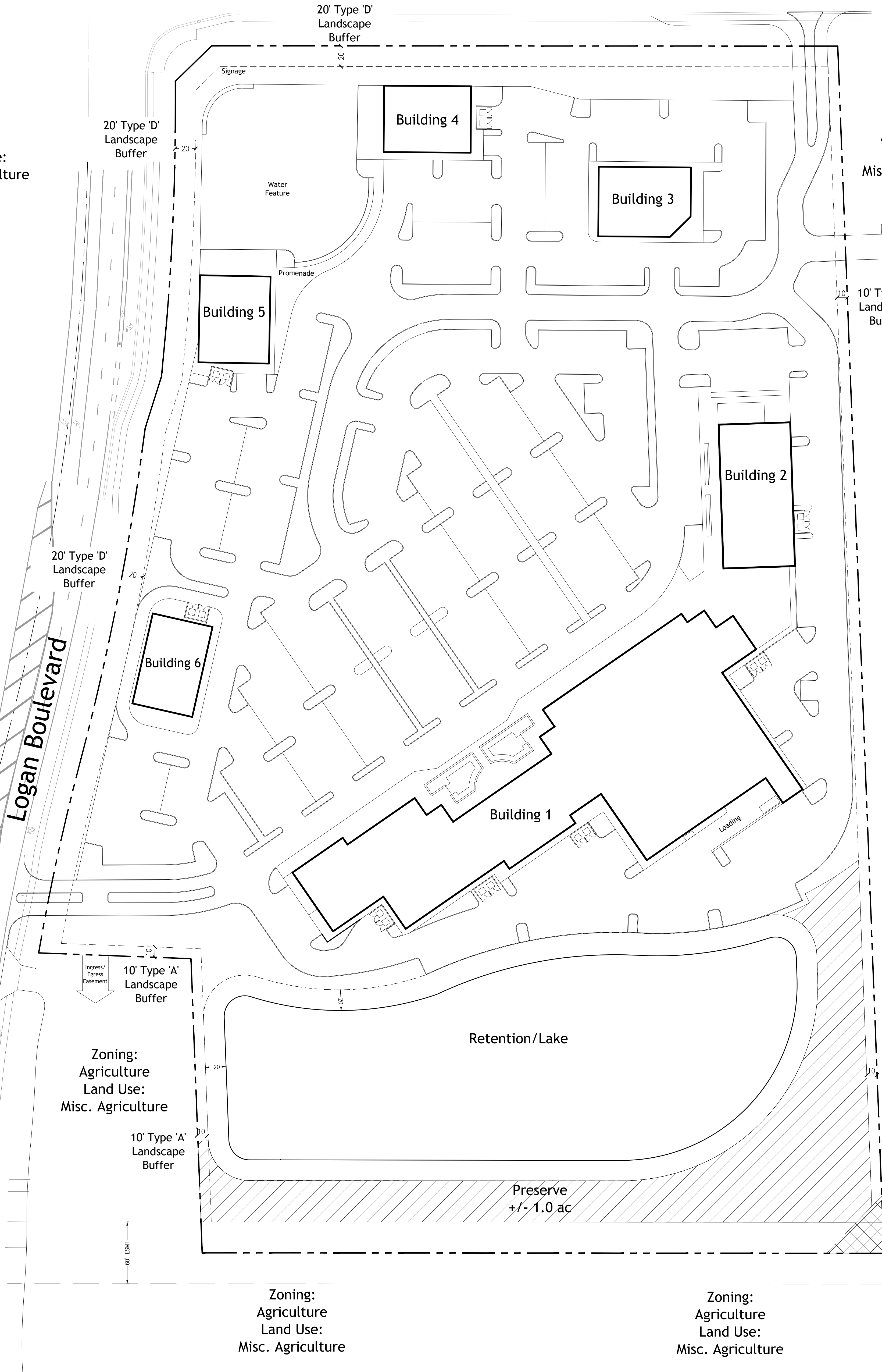

Site Data:

Site acreage:	18.6 acres
Buildings:	100,000 SF
Parking:	650+ spaces
Lake:	2.12 acres (11.4 % of site)
Preserve:	1.0 acres (5.4 % of site)

Preserves and the Native Vegetation Buffer Tract may be used to satisfy the landscape buffer requirements after exotic removal in accordance with LDC section 4.06.02 and LDC section 4.06.05.E.1; supplemental plantings with native plant materials shall be in accordance with LDC Section 3.05.07.



NAPLES COMMERCIAL CENTER
MASTER CONCEPT PLAN GL COMMERCIAL

